

MODIFIED BUILDING PLAN

FILE NO:- P-522/ R-357 /2115-2023

PROJECT.

MODIFIED BUILDING &
PROPOSED INTERIOR
LAYOUT PLAN OF THE
"PUNJAB & SINDH BANK"
BRANCH - **CIVIL LINE**
ROORKEE

OPTION :- 05

DATE :- 01.NOV. 2025 - SATURDAY

SPACE FOR OFFICE USE:-

DETAIL OF AREA CHART

	In Sq.ft.
CARPET AREA OF HALL	1341.32
CARPET AREA OF ATM	0064.16
TOTAL CARPET AREA	1405.48
CARPET AREA OF TOILETS (NOT COUNTED IN CARPET AREA)	0026.33

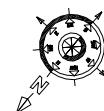

FLOOR NO.- GROUND FLOOR

HEIGHT WITHOUT SLAB:-
UP TO BEAM 10'-00"
FULL HEIGHT 10'-11"

ANY INQUIREY / INFORMATION
CONTACT TO:- Ar.ABDUL MANNAN
MOB.09997339956,0983793338



Ar.MANMEET SINGH BAJAJ

W/S BAJAJ & ASSOCIATES
ARCHITECT, ENGINEERS PLANNERS & VALUERS,
SOPHIA MARKET COURT ROAD, SAHARANPUR-247001
TEL.No.- 0132-2243566,09870-09800, 098370-23500
email- manmeet225@yahoo.com

CORPORATE OFFICE :- B-24 GROUND FLOOR
SEC-44 NOIDA-201301(U.P.)

BRANCH OFFICE :- (01)- H.NO. 197/ 8 / 1 RAJPUR ROAD
DEHRADUN- 248001 (U.K.)
(02)- 333 LAINE NO.02, SIVA RAM VIHAR
NEAR INDIAN OIL PUMP, TAKROHI,
INDIRA NAGAR, LUCKNOW 226016(UP)
(03)- H.NO. 5 / 1 A, Aman NAGAR, opp
DMW workshop,Patla

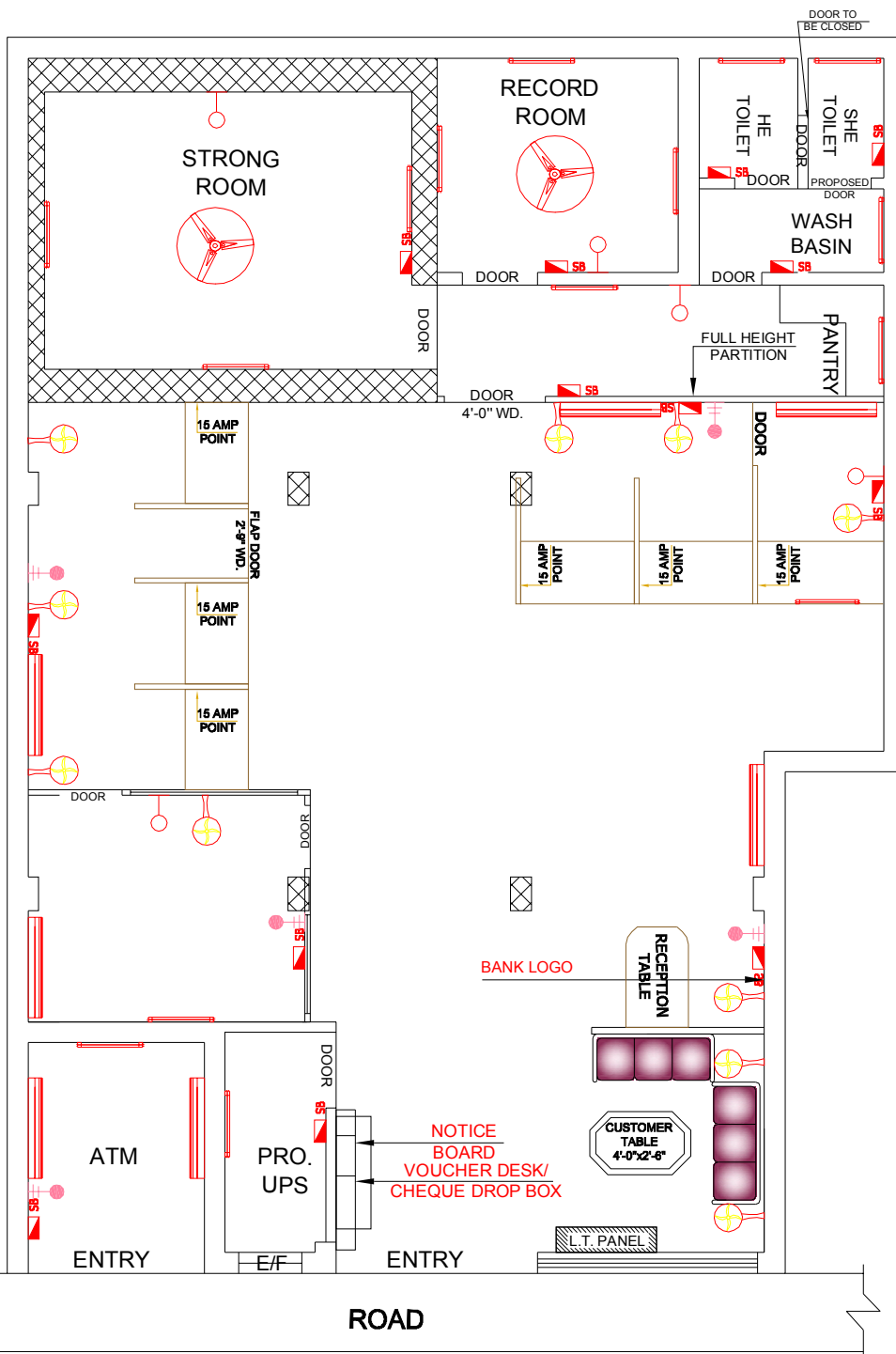

MODIFIED BUILDING PLAN

FILE NO:- P-522/ R-357 /2115-2023

PROJECT.

MODIFIED BUILDING &
PROPOSED INTERIOR
LAYOUT PLAN OF THE
"PUNJAB & SINDH BANK"
BRANCH - CIVIL LINE
ROORKEE

ELECTRICAL DRAWING

DATE :- 01.NOV. 2025 - SATURDAY

SPACE FOR OFFICE USE:-

LEGENDS -FOR ELECTRICAL POINTS

	CEILING FAN 1200MM DIA
	WALL BRACKET LIGHT
	SWITCH BOARD
	WALL FAN
	WALL MOUNTED TUBE LIGHT FIXTURE
	A.C. POINT
	SPLIT A.C

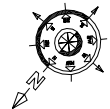

FLOOR NO.- GROUND FLOOR

HEIGHT WITHOUT SLAB:-
UP TO BEAM 10'-00"
FULL HEIGHT 10'-11"

ANY INQUIREY /INFORMATION
CONTACT TO:- Ar.ABDUL MANNAN
MOB.09997339956,09837933338



Ar.MANMEET SINGH BAJAJ

M/S BAJAJ & ASSOCIATES
ARCHITECT, ENGINEERS PLANNERS & VALUERS,
SOPHIA MARKET COURT ROAD,BAHARANPUR,247001
TEL.No.- 0132-2724366,098970-99906, 098370-23300
email- manmeet225@yahoo.com

CORPORATE OFFICE :- B-24 GROUND FLOOR

SEC-44,NOIDA-201301(U.P.)

BRANCH OFFICE :- (01)- H.NO. 197/ 8/ 1 RAJPUR ROAD

DEHRADUN -248001 (U.K)

(02)- 333 LANE NO 02, SIYA RAM VIHAR

NEAR INDIAN OIL PUMP, TAKROHI,

INDIRA NAGAR, LUCKNOW 226016(UP)

(03)- H.NO. 5/1 A, Aman NAGAR, opp

DMW workshop,Patla

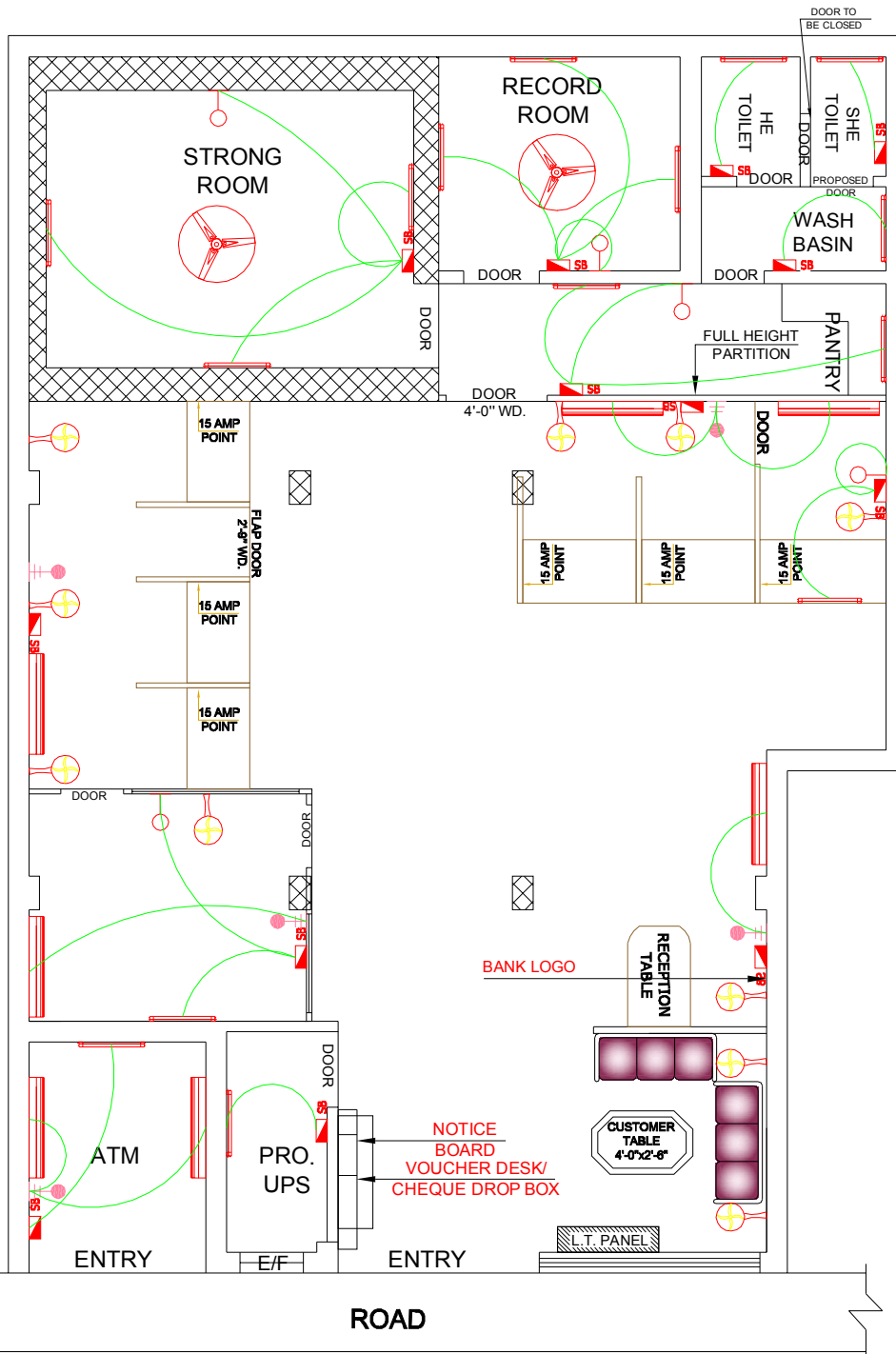

MODIFIED BUILDING PLAN

FILE NO:- P-522/ R-357 /2115-2023

PROJECT.

MODIFIED BUILDING &
PROPOSED INTERIOR
LAYOUT PLAN OF THE
"PUNJAB & SINDH BANK "
BRANCH - CIVIL LINE
ROORKEE

ELECTRICAL WIRING DRAWING
DATE :- 01.NOV. 2025 - SATURDAY

SPACE FOR OFFICE USE:-

LEGENDS -FOR ELECTRICAL POINTS

	CEILING FAN 1200MM DIA
	WALL BRACKET LIGHT
	SWITCH BOARD
	WALL FAN
	WALL MOUNTED TUBE LIGHT FIXTURE
	A.C POINT
	SPLIT A.C

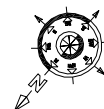

FLOOR NO.- GROUND FLOOR

HEIGHT WITHOUT SLAB:-
UP TO BEAM 10'-00"
FULL HEIGHT 10'-11"

ANY INQUIREY /INFORMATION
CONTACT TO:- Ar.ABDUL MANNAN
MOB.09997339956,09837933338



Ar.MANMEET SINGH BAJAJ
M/S BAJAJ & ASSOCIATES
ARCHITECT, ENGINEERS PLANNERS & VALUERS,
SOPHIA MARKET COURT ROAD,SAHARANPUR-247001
TEL.No.- 0132-2724398,09870-88808, 098370-23300
email- manmeet225@yahoo.com

CORPORATE OFFICE :- B-24 GROUND FLOOR
SEC-44 NOIDA-201301(U.P.)
BRANCH OFFICE :- (01)- H.NO. 197/ 8/ 1 RAJPUK ROAD
.DEHRADUN -248001 (U.K)
(02)- 333 LANE NO 02, SIYA RAM VIHAR
NEAR INDIAN OIL PUMP, TAKROHI,
INDIRA NAGAR, LUCKNOW 226016(UP)
(03)- H.No. 5/1 A, Aman NAGAR, opp
DMW workshop,Patla

FILE NO.- P-522/ R-357 /2115-2023

PROJECT.

MODIFIED BUILDING &
PROPOSED INTERIOR
LAYOUT PLAN OF THE
"PUNJAB & SINDH BANK "
BRANCH - CIVIL LINE
ROORKEE

FALS CEILING

DATE :- 01.NOV. 2025 - SATURDAY

SPACE FOR OFFICE USE:-

DETAIL OF AREA CHART	In Sq. fts.
CARPET AREA OF HALL	1341.32
CARPET AREA OF ATM	0064.16
TOTAL CARPET AREA	1405.48
CARPET AREA OF TOILETS (NOT COUNTED IN CARPET AREA)	0028.33

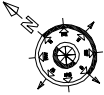

FLOOR NO.- GROUND FLOOR

HEIGHT WITHOUT SLAB:-
UP TO BEAM 10'-00"
FULL HEIGHT 10'-11"

ANY INQUIREY /INFORMATION
CONTACT TO:- AT.ABDUL MANNAN
MOB.09997339956,09837933338

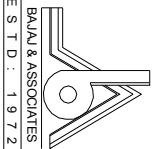

BAJAJ & ASSOCIATES
ESTD : 1972

A.C.MANMEET SINGH BAJAJ

M/S BAJAJ & ASSOCIATES
ARCHITECT, ENGINEERS & VALUERS
OFFICE : 333 LANE NO.02, SIVARAM VIHAR
NEAR INDIAN OIL PUMP, JAKROHI,
ROORKEE (U.P.) INDIA-248001
TEL.No.-0522-272081,0522-26004, 0522-26200
email- manmeet22@bajaj.com
CORPORATE OFFICE :- B-24 GROUND FLOOR
SEC-44, KOTDA-203801 (U.P.)
BRANCH OFFICE :- (01) DEHRADUN-248001 (U.P.)
(02) 333 LANE NO.02, SIVARAM VIHAR
NEAR INDIAN OIL PUMP, JAKROHI,
ROORKEE (U.P.) INDIA-248001
DWG WORKSHEET: 04/25

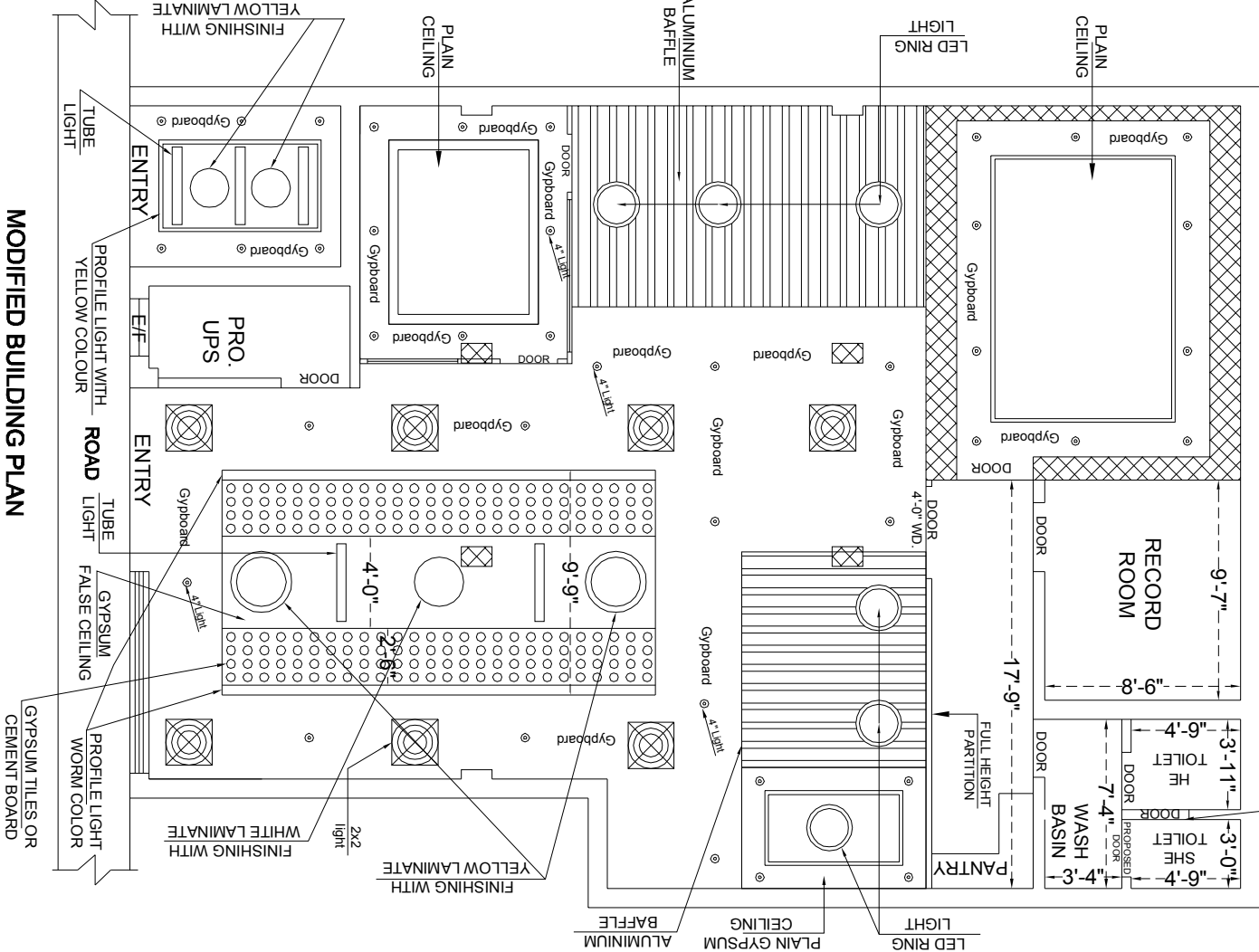

MODIFIED BUILDING PLAN

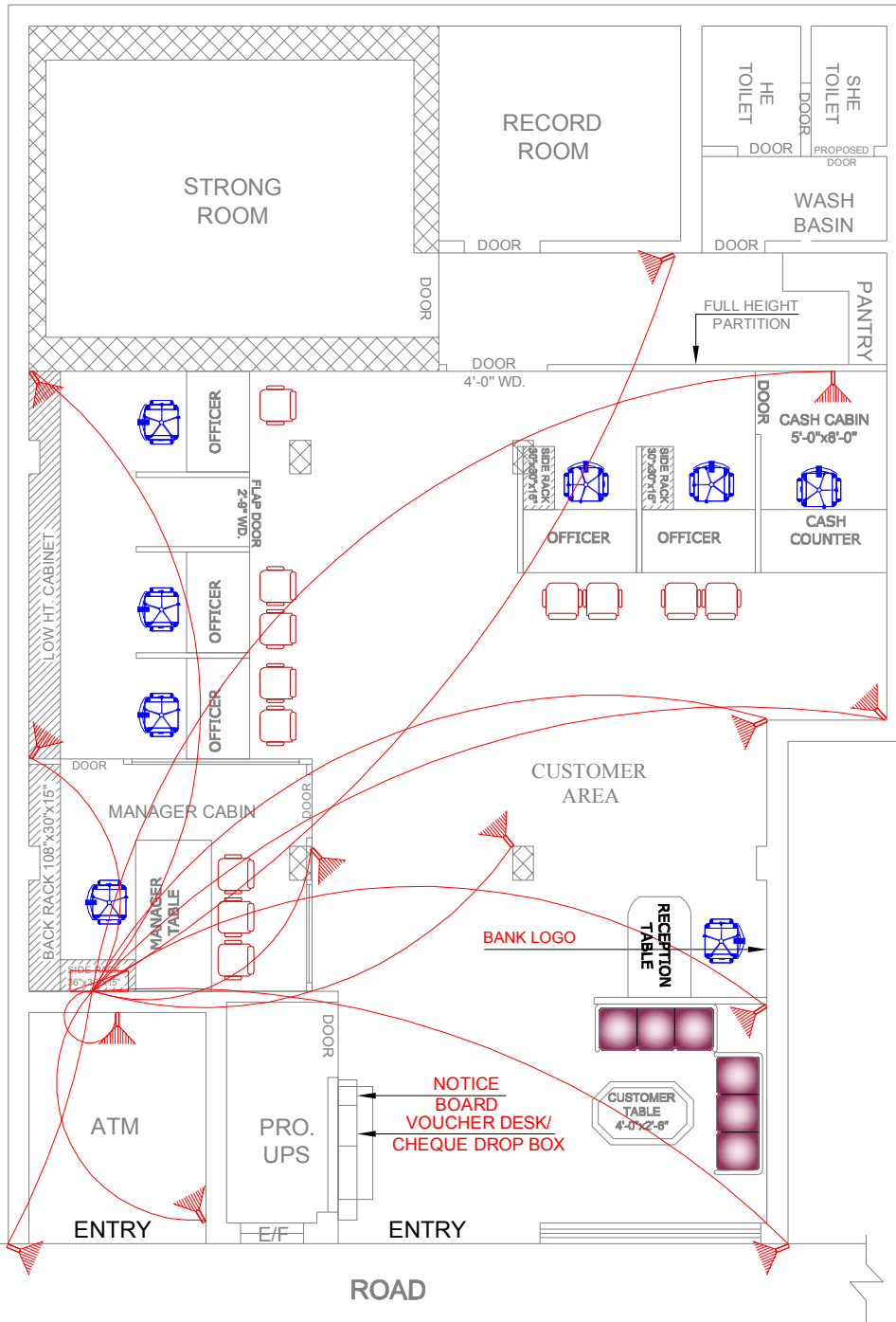

FILE NO:- P-522/ R-357 /2115-2023

PROJECT.

MODIFIED BUILDING &
PROPOSED INTERIOR
LAYOUT PLAN OF THE
"PUNJAB & SINDH BANK "
BRANCH - CIVIL LINE
ROORKEE

CC - TV CAMERA DRAWING

DATE :- 01.NOV. 2025 - SATURDAY

SPACE FOR OFFICE USE:-

LEGENDS	POINTS	NO. OF CC-TV
	CC - TV CAMERA	13

DETAIL OF AREA CHART

	in Sq.fts.
CARPET AREA OF HALL	1341.32
CARPET AREA OF ATM	0064.16
TOTAL CARPET AREA	1405.48
CARPET AREA OF TOILETS (NOT COUNTED IN CARPET AREA)	0026.33

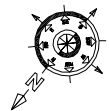

FLOOR NO.- GROUND FLOOR

HEIGHT WITHOUT SLAB:-
UP TO BEAM 10'-00"
FULL HEIGHT 10'-11"

ANY INQUIREY /INFORMATION
CONTACT TO:- Ar.ABDUL MANNAN
MOB.09997339956,09837933338



Ar.MANMEET SINGH BAJAJ

MR BAJAJ & ASSOCIATES
ARCHITECT, ENGINEERS PLANNERS & VALUERS,
80PHIA MARKET COURT ROAD,SAHARANPUR-247001
TEL.No.- 0132-2724369,03670-08008, 036370-23300
email:- manmeet225@yahoo.com

CORPORATE OFFICE :- B-24 GROUND FLOOR
SEC-44,NOIDA-201301(U.P.)
BRANCH OFFICE :- (01)- H.NO. 197/8/1 RAJPUR ROAD
DEHRADUN-248001 (U.K)
(02)- 333 LANE NO 02, SIYA RAM VIHAR
NEAR INDIAN OIL PUMP, TAKROHI,
INDIRA NAGAR, LUCKNOW 226016(UP)
(03)- H.NO. 5/1 A, Aman NAGAR, opp
DMW workshop,Patna

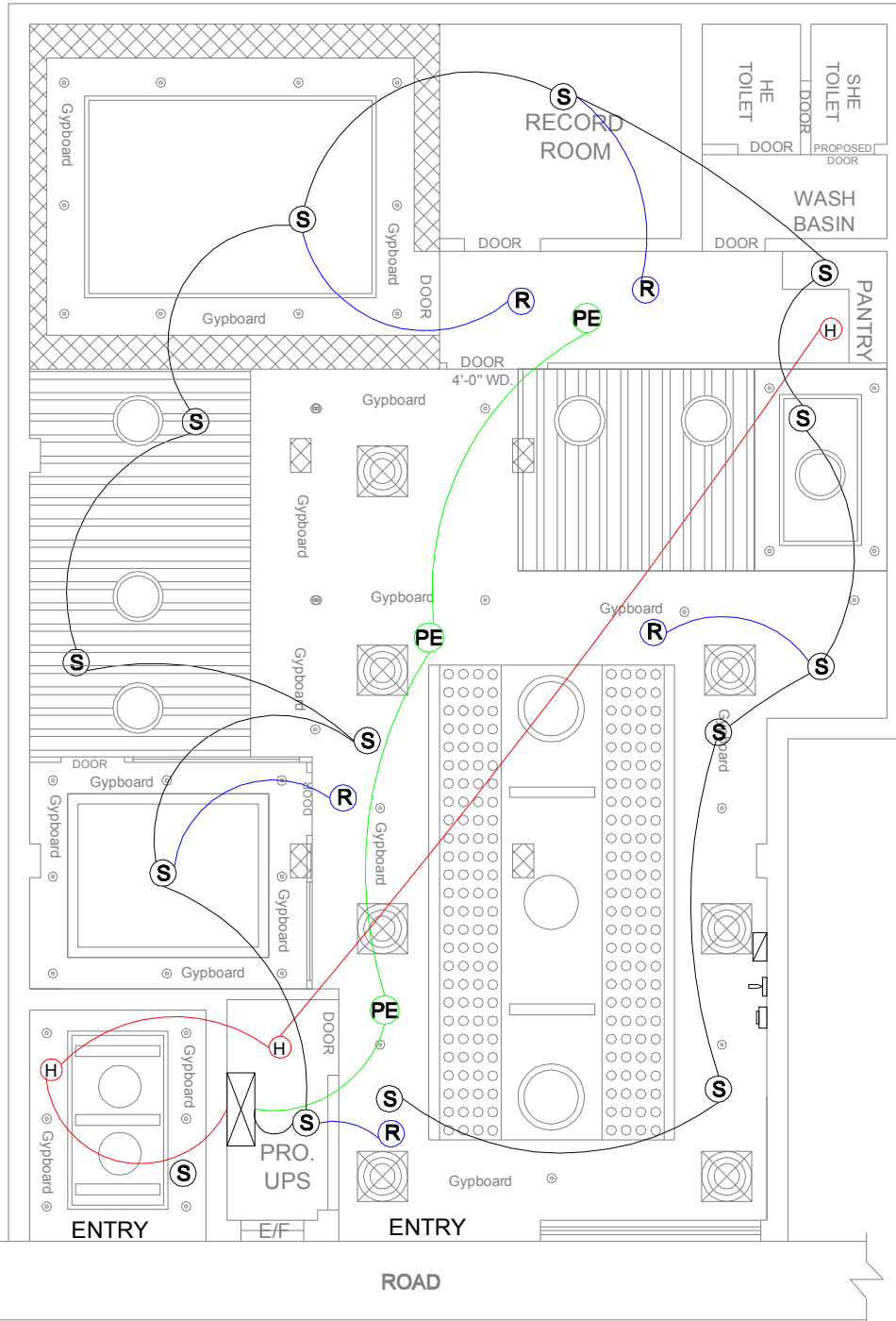

MODIFIED BUILDING PLAN

FILE NO:- P-522/ R-357 /2115-2023

PROJECT.

MODIFIED BUILDING &
PROPOSED INTERIOR
LAYOUT PLAN OF THE
"PUNJAB & SINDH BANK"
BRANCH - CIVIL LINE
ROORKEE

FIRE DRG.

DATE :- 01.NOV. 2025 - SATURDAY

SPACE FOR OFFICE USE:-

S.NO.	SYMBOL	Q.T.	DESCRIPTION	HEIGHT
01.	(S)	11.	SMOKE DETECTOR	GYP. CEILING
02.	(H)	02.	HEAT DETECTOR	CEILING
03.	(R)	04.	RESPONSE INDICATOR	ROOF SLAB
04.	PE	03.	PHOTO ELECTRIC TYPE SMOKE DETECTOR	CEILING
			ABOVE FALSE CEILING	
05	HOOTER	01	HOOTER	
06	MANUAL CALL POINT	01	MANUAL CALL POINT	4'-0" HEIGHT
07	CONTROL PANEL	01	CONTROL PANEL	5'-6" HEIGHT



FLOOR NO.- GROUND FLOOR

HEIGHT WITHOUT SLAB:-
UP TO BEAM 10'-00"
FULL HEIGHT 10'-11"

ANY INQUIREY / INFORMATION
CONTACT TO:- Ar.ABDUL MANNAN
MOB.09997339956,09837933338



Ar.MANMEET SINGH BAJAJ
M/S BAJAJ & ASSOCIATES
ARCHITECT, ENGINEERS PLANNERS & VALUERS,
SOPHIA MARKET COURT ROAD, SAHARANPUR-247001
TEL.No.- 0132-2724368,098970-98908, 098570-23300
email- manmeet226@yahoo.com
CORPORATE OFFICE - B-24 GROUND FLOOR
(SEC-44/NOIDA-201301(U.P.))
BRANCH OFFICE :- (01)- H.NO. 197/ 8 / 1 RAJPUR ROAD
DEHRADUN -248001 (U.K)
(02)- 333 LANE NO 02, SIYA RAM VIHAR
,NEAR INDIAN OIL PUMP, TAKROHI,
INDIRA NAGAR, LUCKNOW 226016(UP)
(03)- H.NO. 5 /1 A, Aman NAGAR, opp
DNW workshop,Patlaia

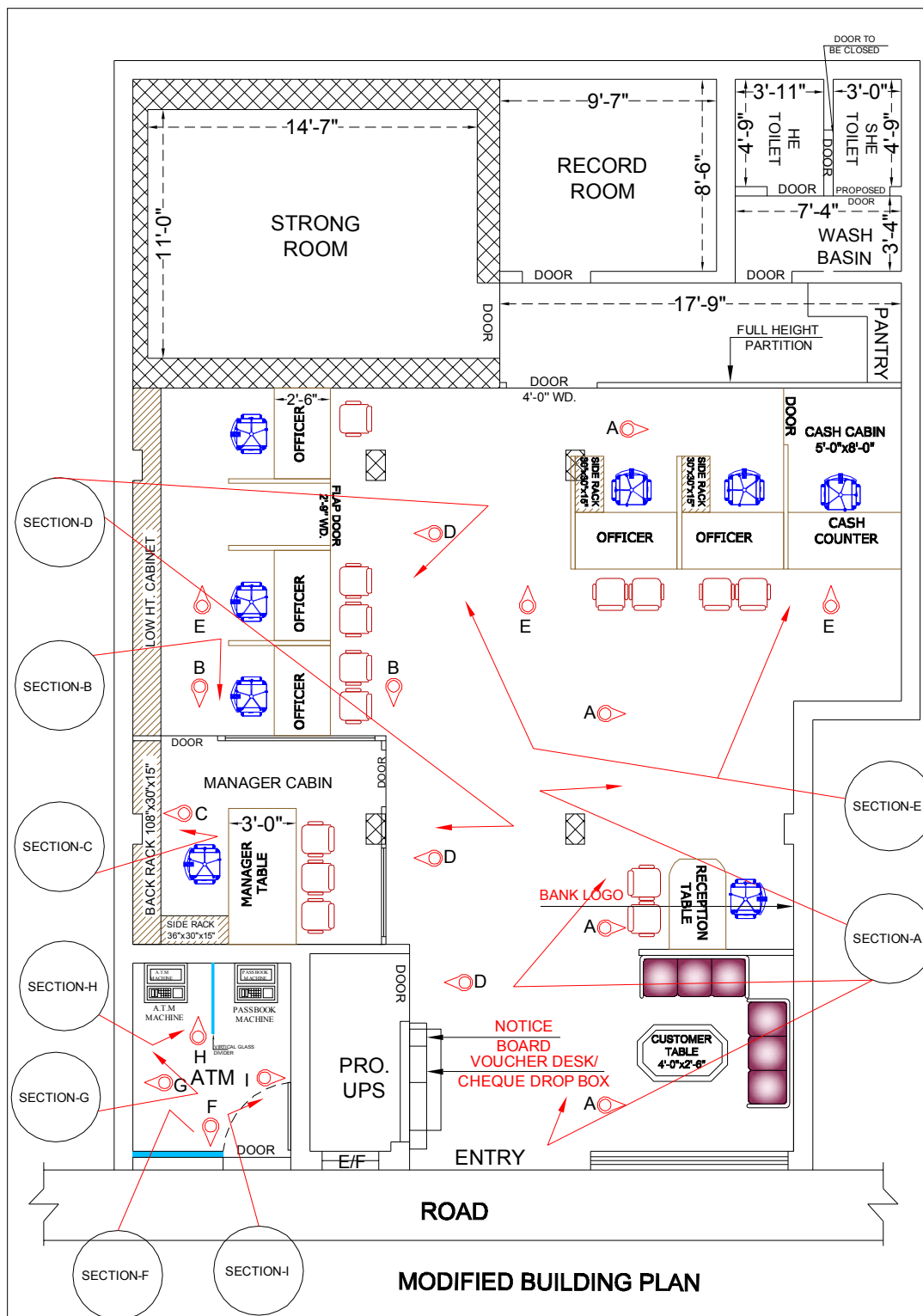

FILE NO:- P-522/ R-357 /2115-2023

PROJECT.

MODIFIED BUILDING &
PROPOSED INTERIOR
LAYOUT PLAN OF THE
"PUNJAB & SINDH BANK"
BRANCH - CIVIL LINE
ROORKEE

SECTION DETAILS

DATE :- 01.NOV. 2025 - SATURDAY

SPACE FOR OFFICE USE:-

DETAIL OF AREA CHART

	In Sq.ft.
CARPET AREA OF HALL	1341.32
CARPET AREA OF ATM	0064.16
TOTAL CARPET AREA	1405.48
CARPET AREA OF TOILETS (NOT COUNTED IN CARPET AREA)	0026.33

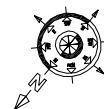

FLOOR NO.- GROUND FLOOR

HEIGHT WITHOUT SLAB:-	
UP TO BEAM	10'-00"
FULL HEIGHT	10'-11"

ANY INQUIREY /INFORMATION
CONTACT TO:- Ar.ABDUL MANNAN
MOB.09997339956,09837933338



Ar.MANMEET SINGH BAJAJ
MR BAJAJ & ASSOCIATES
ARCHITECT, ENGINEERS PLANNERS & VALUERS,
SOPHIA MARKET COURT ROAD,BAHARANPUR-247001
TEL.No.- 0132-2724366,098970-98608, 098370-23300
email:- manmeet226@yahoo.com
CORPORATE OFFICE :- B-24 GROUND FLOOR
SEC-44,NOIDA-201301(U.P.)
BRANCH OFFICE :- (01)- H.NO. 197/ 8 /1 RAJIPUR ROAD
DEHRADUN -248001 (U.K)
(02)- 333 LANE NO 02, SIYA RAM VIHAR
NEAR INDIAN OIL PUMP, TAKROHL
INDIRA NAGAR, LUCKNOW 226016(UP)
(03)- H.NO. 5 /1 A, Aman NAGAR, opp
DMW workshop,Patiala

FILE NO.- P-522/ R-357 /2/115-2023

PROJECT.

MODIFIED BUILDING &
PROPOSED INTERIOR
LAYOUT PLAN OF THE
"PUNJAB & SINDH BANK"
BRANCH - CIVIL LINE
ROORKEE

A-SIDE WALL ELEVATION- MAIN ENTRY'S RIGHT SIDE

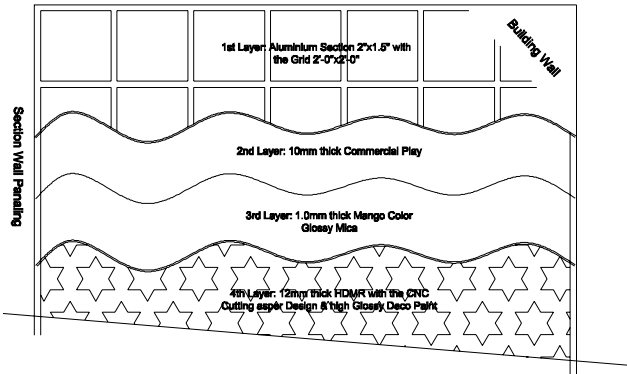
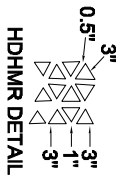
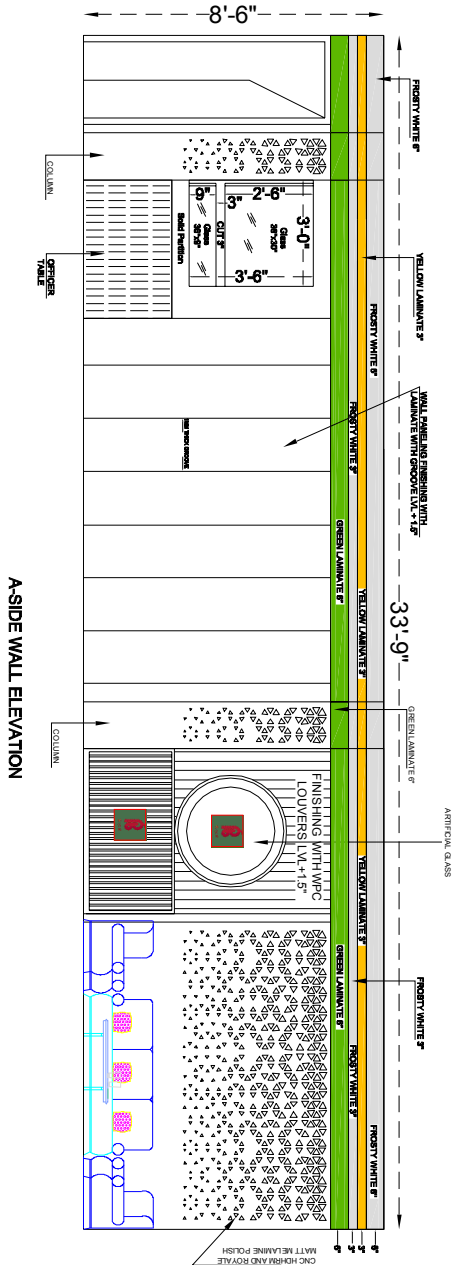
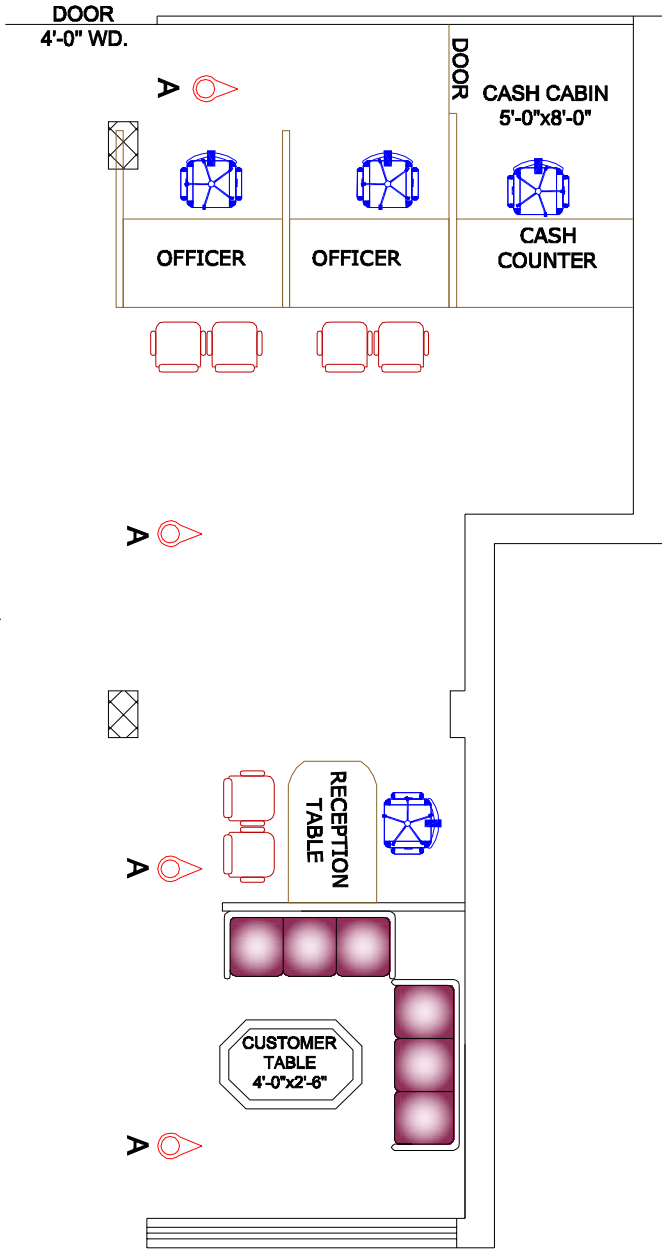

ANY INQUIREY / INFORMATION
CONTACT TO:- A: ABDUL MANNAN
MOB.09997339956,09837933338

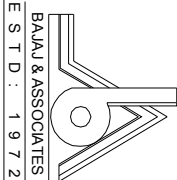

A: MANMEET SINGH BAJAJ

ARCHITECT, ENGINEER PLANNERS & VALUERS
SPECIALISTS IN ARCHITECTURE, INTERIOR DESIGN
TEL.No. 01824724266,09870-68006, 098379-23300
email- manmeet25@gmail.com
CORPORATE OFFICE :- B-24 GROUND FLOOR
SEC-44 NOIDA-201301(U.P.)
BRANCH OFFICE :- (01)- H.NO. 197/8/1 RAIPUR ROAD
DEHRADUN-248001 (U.K.)
(02)- 333 LANE NO 02, SYA RAM VIHAR
NEAR INDIAN OIL PUMP, TANKROHI,
INDIRA NAGAR, LUCKNOW 226016(U.P.)
(03)- H.NO. 5/1 A, Arun NAGAR, opp
DMW Workshop,Patlaa

PROJECT.

MODIFIED BUILDING &
PROPOSED INTERIOR
LAYOUT PLAN OF THE
"PUNJAB & SINDH BANK "
BRANCH - CIVIL LINE
ROORKEE

B-SIDE WALL ELEVATION - MANAGER CABIN SIDE PARTITION

ANY INQUIREY /INFORMATION
CONTACT TO:- **AR. ABDUL MANNAN**
MOB.09997339956,09837933338

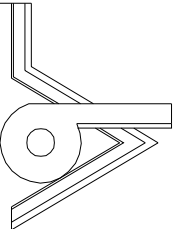

BAJAJ & ASSOCIATES

E S T D : 1 9 7 2

AJ.MANMEET SINGH BAJAJ

M/S BAJAJ & ASSOCIATES

ARCHITECT, ENGINEERS PLANNERS & VALUERS,

SOPHIA MARKET COURT ROAD,SAHARANPUR-247001

TEL.No.- 0132-2724396,098970-66906, 098370-23300

email:- manmeet25@yahoo.com

CORPORATE OFFICE :- B-24 GROUND FLOOR

,SEC-44,NOIDA-201301(U.P.)

BRANCH OFFICE :- (01)- H.NO. 197/ 8 /1 RAJPUUR ROAD

DEHRADUN -248001 (U.K)

(02)- 333 LANE NO 02, SIYA RAM VIHAR

,NEAR INDIAN OIL, PUMP, TAKROHI,

INDIRA NAGAR, LUCKNOW 226016(UP)

(03)- H.NO. 5 /1 A, Aman NAGAR, opp

DMW workshop,Patlaia

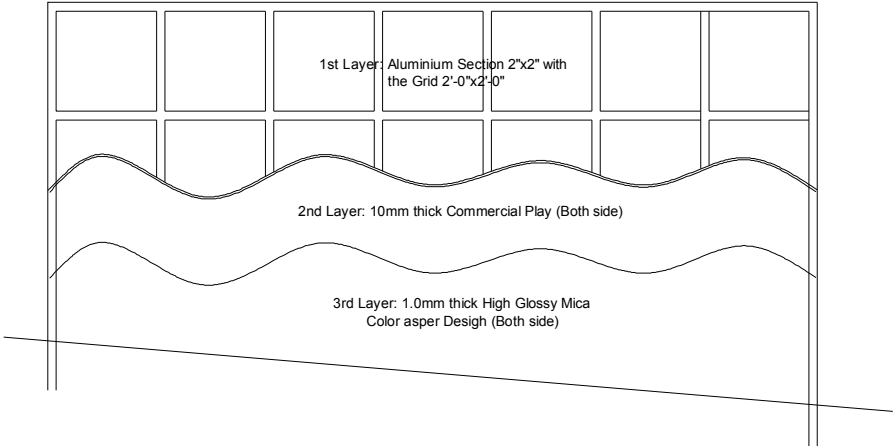
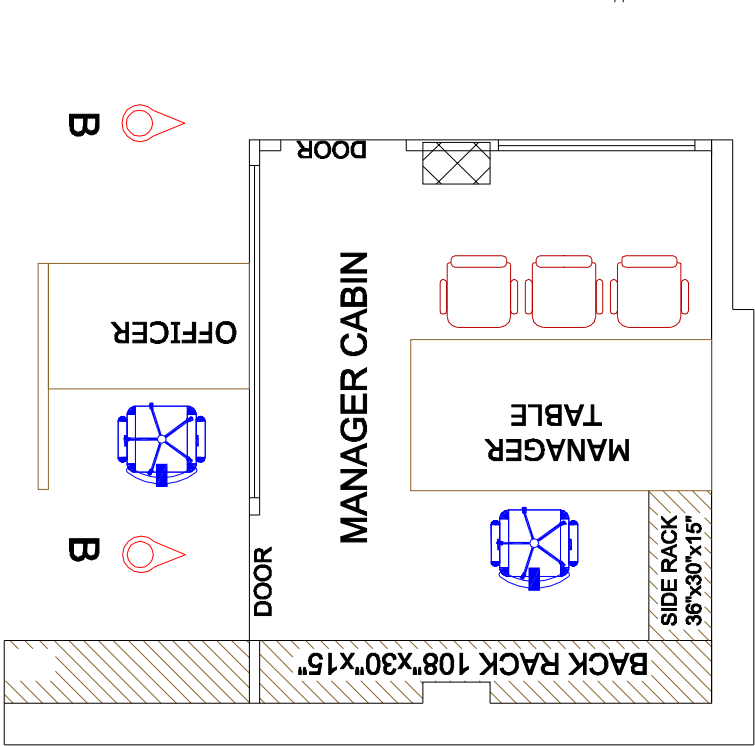

Section Full Low ht Glazed & Solid/Block
Double Side Laminate Partition

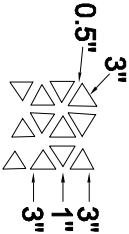

HDHMR DETAIL

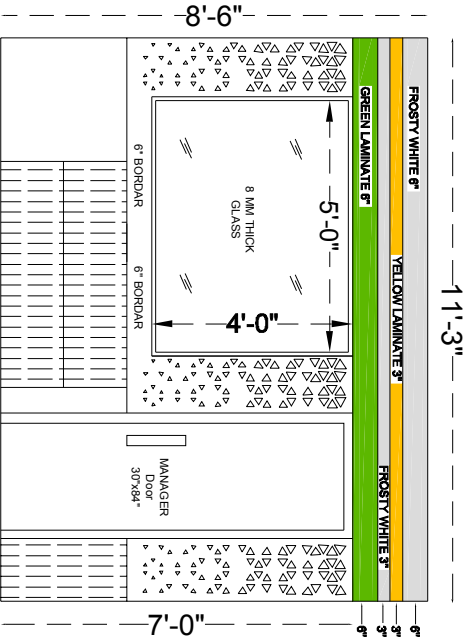

B-SIDE WALL ELEVATION

FILE NO:- P-522/ R-357 /2115-2023

PROJECT.

MODIFIED BUILDING &
PROPOSED INTERIOR
LAYOUT PLAN OF THE
"PUNJAB & SINDH BANK"
BRANCH - CIVIL LINE
ROORKEE

C-SIDE WALL ELEVATION - MANAGER CABIN

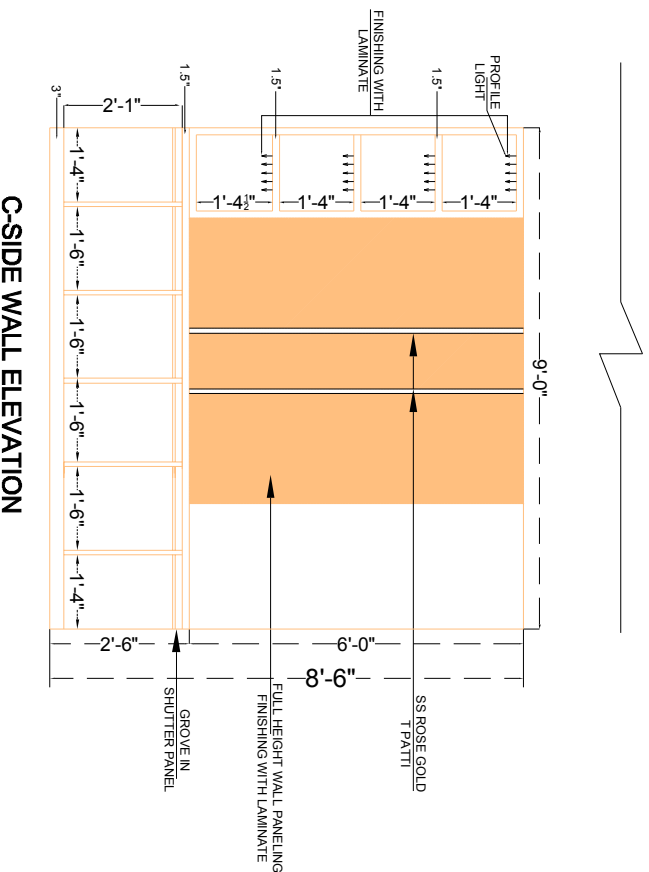
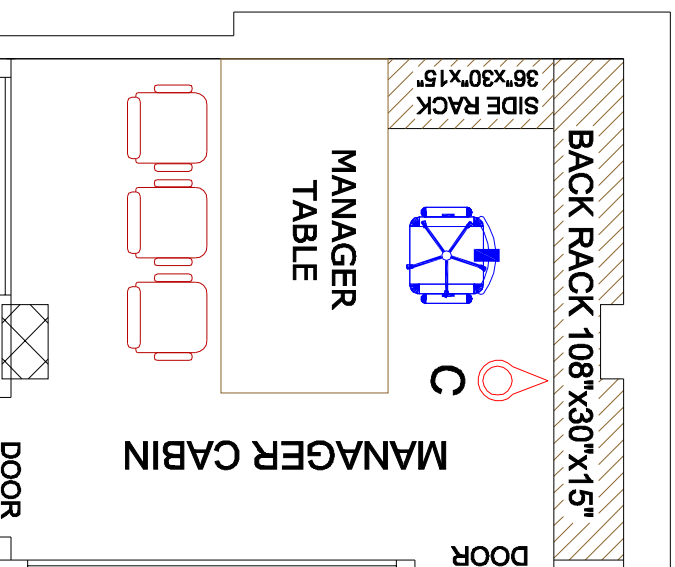

ANY INQUIREY /INFORMATION
CONTACT TO:- AP. ABDUL MANNAN
MOB.09997339956,09837933338

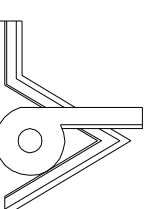

BAJAJ & ASSOCIATES

E S T D : 1 9 7 2

A.P.MANMEET SINGH BAJAJ

M/S BAJAJ & ASSOCIATES
ARCHITECT, ENGINEERS PLANNERS & VALUERS,
SOPHIA MARKET COURT ROAD, SAHARANPUR-247001
TEL.No.- 0132-2724366,098970-66906, 098370-23300
email- manmeet225@yahoo.com

CORPORATE OFFICE :- B-24, GROUND FLOOR

SEC-44 NOIDA-201301(U.P)

BRANCH OFFICE :- (01)-H.NO. 197/8 / 1 RAJPUR ROAD

DEHRADUN-248001 (U.K)

(02)- 333 LANE NO 02, SITTA RAM VIHAR

NEAR INDIAN OIL PUMP, TAKROHI,

INDIRA NAGAR, LUCKNOW 226016(U.P)

(03)- H.NO. 5/1 A, Aman NAGAR, opp

DMV workshop, Patlaa

FILE NO:- P-522/ R-357 /2115-2023

PROJECT.

MODIFIED BUILDING &
PROPOSED INTERIOR
LAYOUT PLAN OF THE
"PUNJAB & SINDH BANK"
BRANCH - CIVIL LINE
ROORKEE

D-SIDE WALL ELEVATION- MAIN ENTRY'S LEFT SIDE

ANY INQUIREY / INFORMATION
CONTACT TO:- A.P. ABDUL MANNAN
MOB.09997339956,09837933338

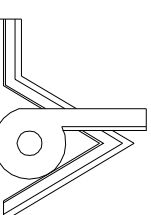

BAJAJ & ASSOCIATES

E S T D : 1 9 7 2

A.P. MANMJEET SINGH BAJAJ

M/S BAJAJ & ASSOCIATES

ARCHITECT, ENGINEERS PLANNERS & VALUERS,

SOPHIA MARKET COURT ROAD SAHARANPUR-247001

TEL.No.- 0132-2724396,098870-66906, 098370-23300

email- manmjeet225@yahoo.com

CORPORATE OFFICE :- B-24 GROUND FLOOR

SEC-44 NOIDA-201301(U.P.)

BRANCH OFFICE :- (01)- H.NO. 197/8/1 RAJAPUR ROAD

DEHRADUN-248001 (U.K)

(02)- 333 LANE NO 02, SIYA RAM VIHAR

NEAR INDIAN OIL PUMP, TAKROHI,

INDIRA NAGAR, LUCKNOW 226016(U.P)

(03)- H.NO. 5/1/A, Aman NAGAR, opp

DMV Workshop,Patlaia

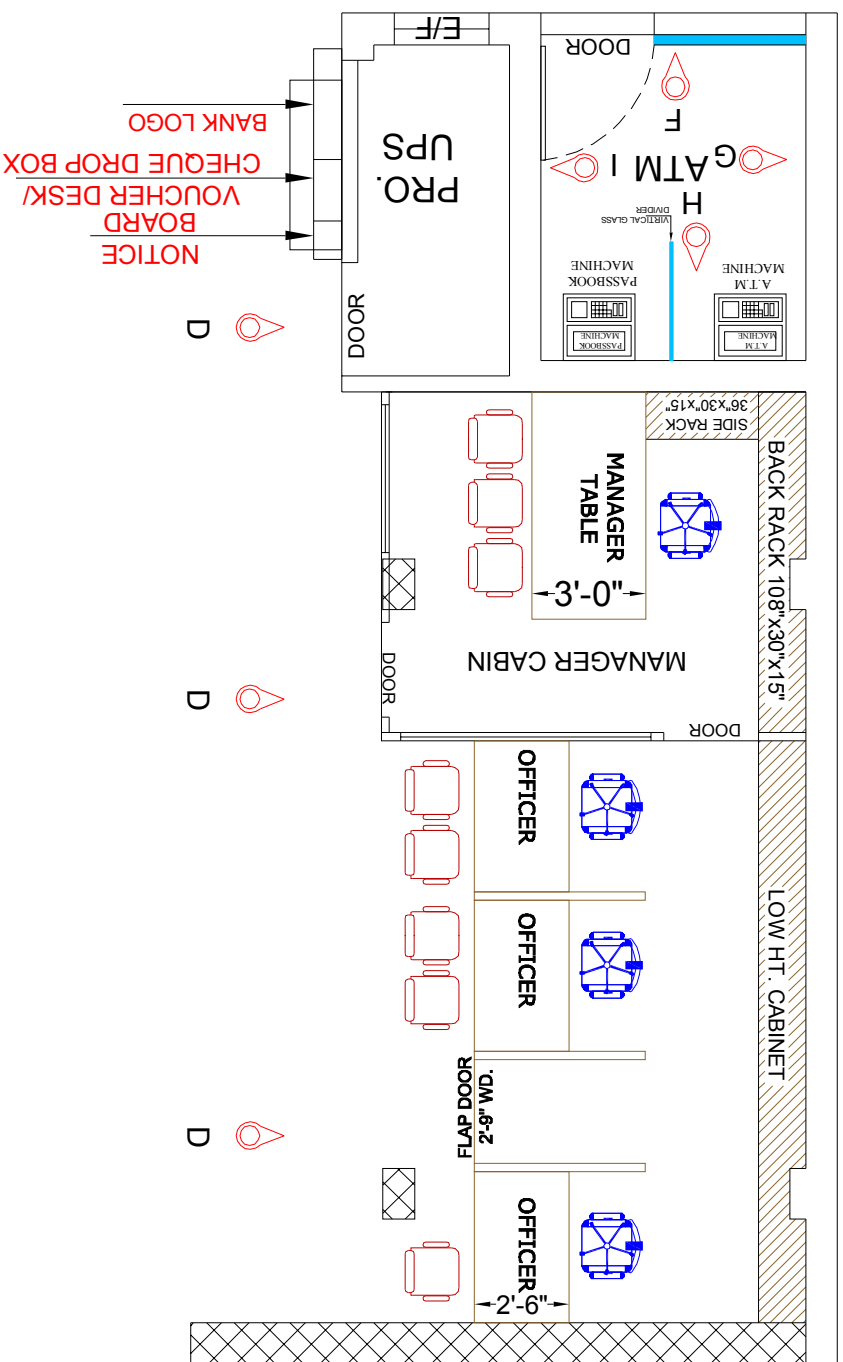

D-SIDE WALL ELEVATION

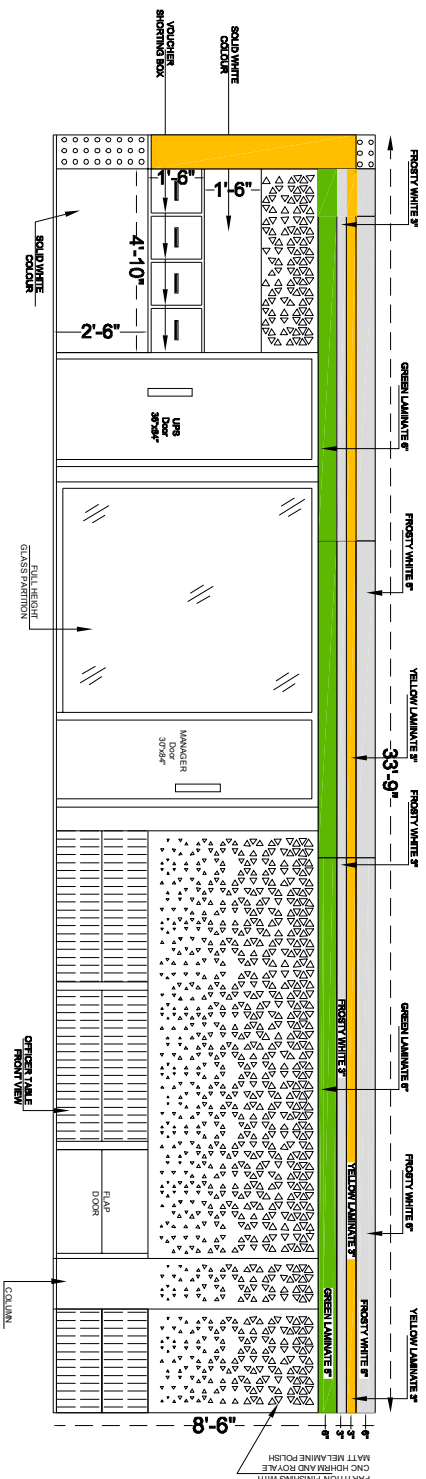

PROJECT.

E-SIDE WALL ELEVATION - MAIN ENTRY'S FRONT

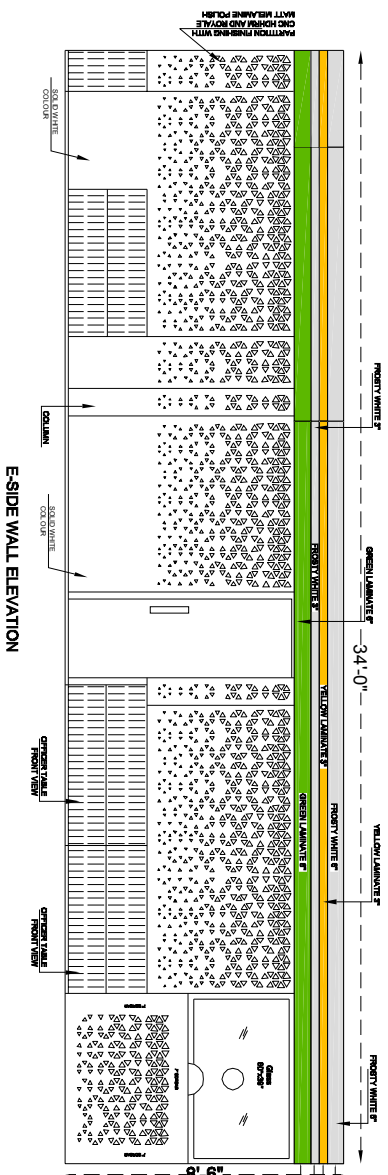

BAJAJ & ASSOCIATES
E S T D : 1 9 7 2

M/S BALAJI & ASSOCIATES
ARCHITECT, ENGINEERS PLANNERS & VALUERS,
SOPHIA MARKET COURT ROAD, SAHARANPUR-247001
TEL.No.- 0132-2724396, 096970-66906, 096370-23300
email- mamtee225@yahoo.com

CORPORATE OFFICE :- B-24 GROUND FLOOR

, SEC-44, NOIDA-201301(U.P.)
BRANCH OFFICE :- (01)-H.NO. 197/ 8 / 1 RAJPUR ROAD

**(02)- 333 LANE NO 02, SIYA RAM VIHAR
NEAR INDIAN OIL PUMP, TAKROHI,
INDIRA NAGAR, LUCKNOW 226016(UP)
(03)- H.NO. 5 /1 A, Aman NAGAR, opp
DMW workshop, Patiala**

FILE NO:- P-522/ R-357 /2115-2023

PROJECT.

MODIFIED BUILDING &
PROPOSED INTERIOR
LAYOUT PLAN OF THE
"PUNJAB & SINDH BANK "
BRANCH - **CIVIL LINE**
ROORKEE

F-SIDE WALL ELEVATION - ATM FRONT SIDE WALL

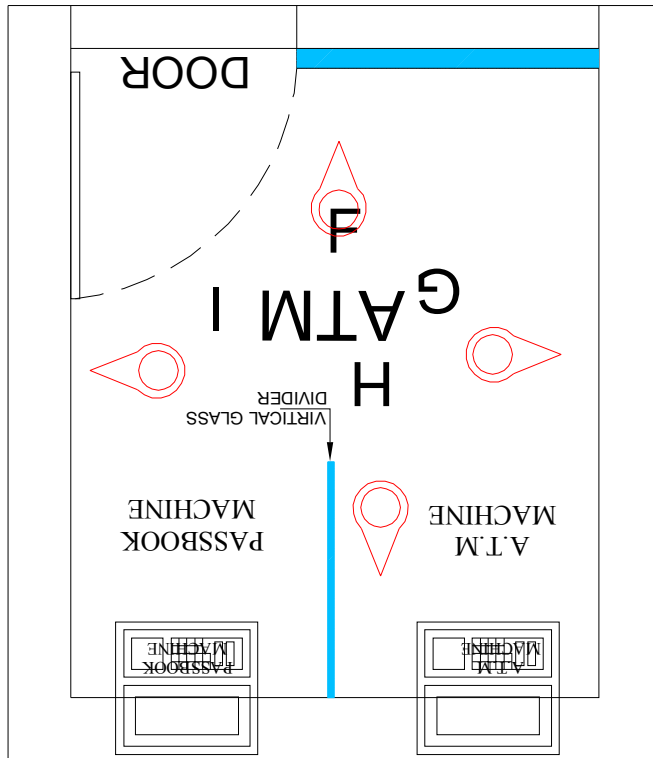

F

7'-0"

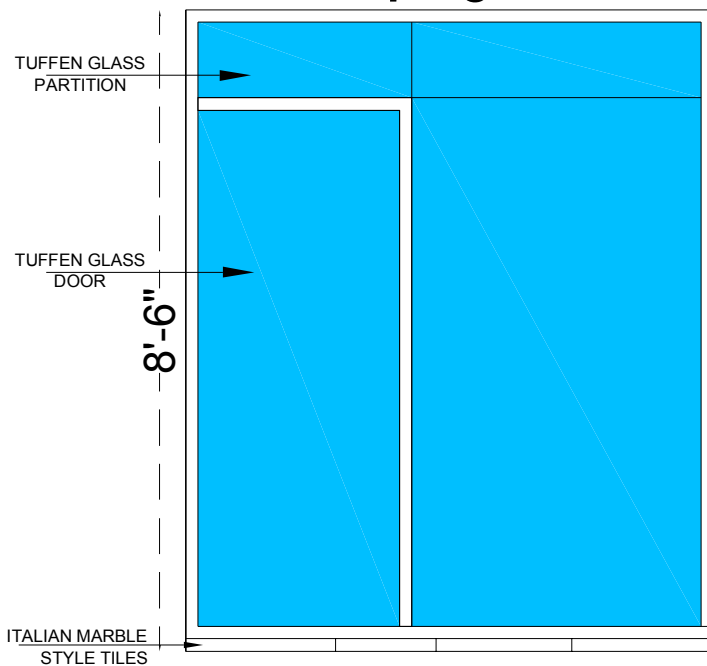

F-SIDE WALL ELEVATION

ANY INQUIREY /INFORMATION
CONTACT TO:- Ar. ABDUL MANNAN
MOB.09997339956,09837933338

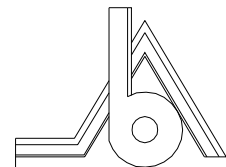

BAJAJ & ASSOCIATES

E S T D : 1 9 7 2

Ar.MANMEET SINGH BAJAJ

M/S BAJAJ & ASSOCIATES
ARCHITECT, ENGINEERS PLANNERS & VALUERS,
SOPHIA MARKET COURT ROAD,SAHARANPUR-247001
TEL.No.- 0132-2724396,098970-66906, 098370-23300
email- manmeet225@yahoo.com

CORPORATE OFFICE :- B-24 GROUND FLOOR
SEC-44,NOIDA-201301(U.P.)

BRANCH OFFICE :- (01)- H.NO. 197/ 8 / 1 RAJPUR ROAD
,DEHRADUN -248001 (U.K)

(02)- 333 LANE NO 02, SIYA RAM VIHAR
,NEAR INDIAN OIL PUMP, TAKROHI,
INDIRA NAGAR, LUCKNOW 226016(UP)

(03)- H.NO. 5 /1 A, Aman NAGAR, opp
DMW workshop,Patāla

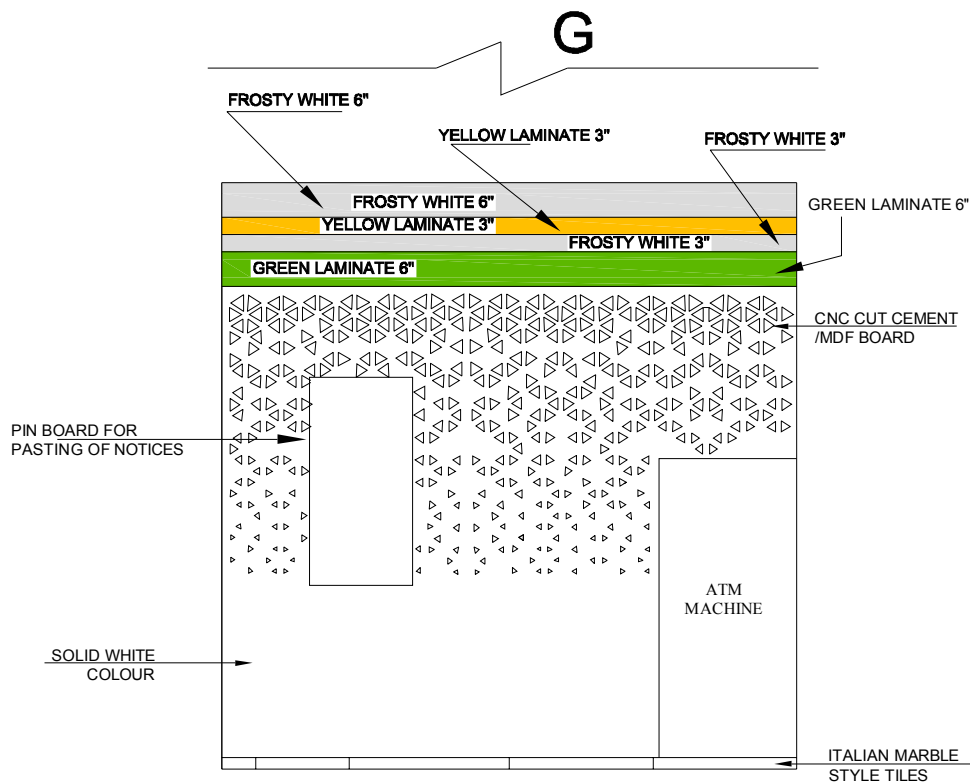
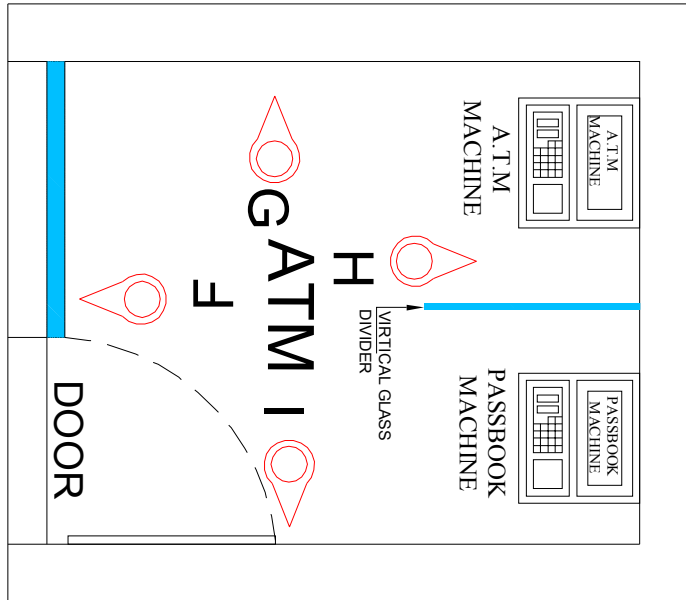

G-SIDE WALL ELEVATION

FILE NO:- P-522/ R-357 /2115-2023

PROJECT.

MODIFIED BUILDING &
PROPOSED INTERIOR
LAYOUT PLAN OF THE
"PUNJAB & SINDH BANK"
BRANCH - **CIVIL LINE**
ROORKEE

G-SIDE WALL ELEVATION - ATM LEFT SIDE WALL

ANY INQUIREY /INFORMATION
CONTACT TO:- Ar. ABDUL MANNAN
MOB.09997339956,09837933338

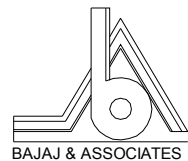

BAJAJ & ASSOCIATES
ESTD : 1972

Ar.MANMEET SINGH BAJAJ

M/S BAJAJ & ASSOCIATES
ARCHITECT, ENGINEERS PLANNERS & VALUERS,
SOPHIA MARKET COURT ROAD,SAHARANPUR-247001
TEL.No.- 0132-2724366,098970-86906, 098370-23300
email- manmeet225@yahoo.com

CORPORATE OFFICE :- B-24 GROUND FLOOR
,SEC-44,NOIDA-201301(U.P.)

BRANCH OFFICE :- (01)- H.NO. 197/ 8 / 1 RAJPUR ROAD
,DEHRADUN -248001 (U.K)
(02)- 333 LANE NO 02, SIYA RAM VIHAR
,NEAR INDIAN OIL PUMP, TAKROHI,
INDIRA NAGAR, LUCKNOW 226016(UP)
(03)- H.NO. 5 /1 A, Aman NAGAR, opp
DMW workshop,Patiala

FILE NO:- P-522/ R-357 /2115-2023

PROJECT.

MODIFIED BUILDING &
PROPOSED INTERIOR
LAYOUT PLAN OF THE
"PUNJAB & SINDH BANK"
BRANCH - **CIVIL LINE**
ROORKEE

H-SIDE WALL ELEVATION - ATM BACK WALL

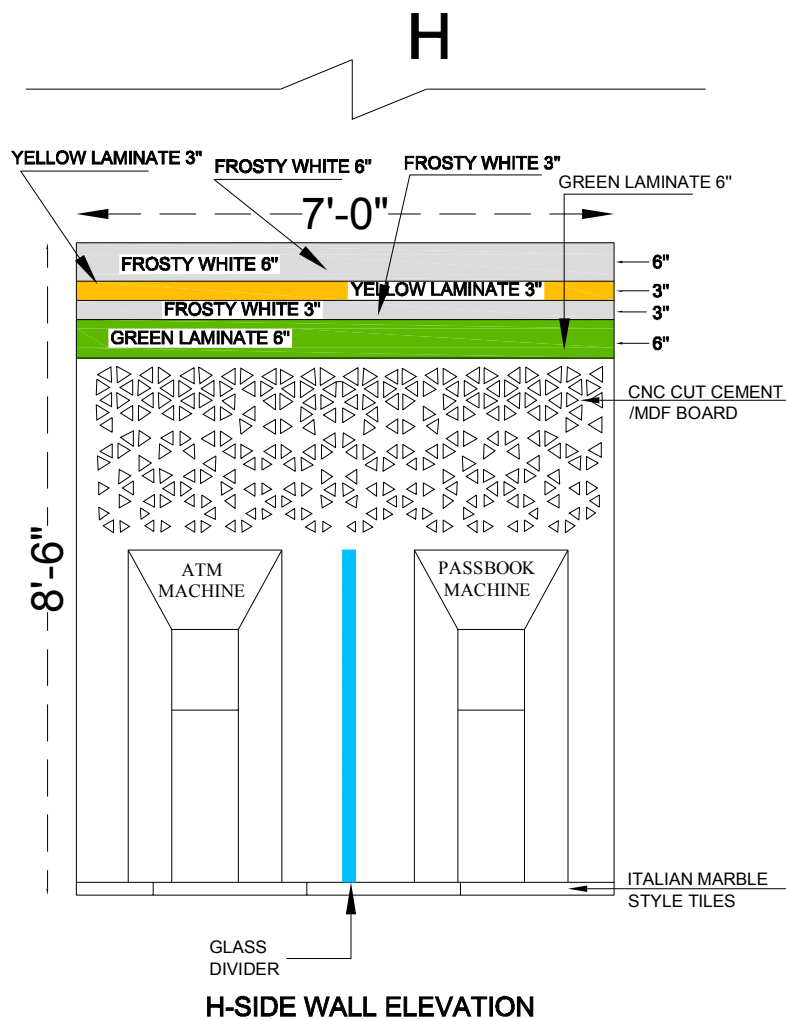
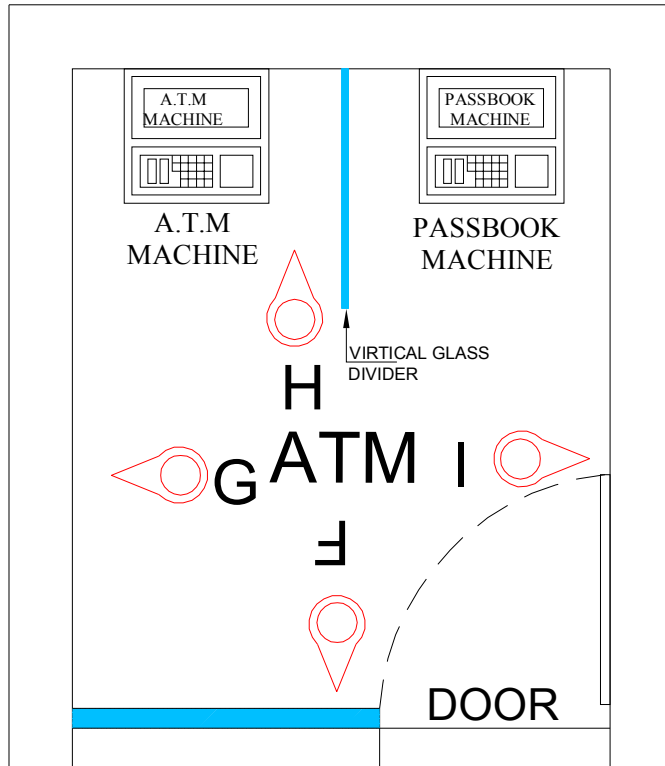

ANY INQUIREY /INFORMATION
CONTACT TO:- Ar. ABDUL MANNAN
MOB.09997339956,09837933338

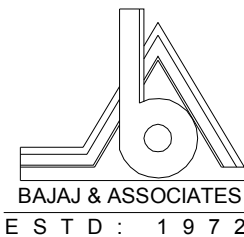

Ar.MANMEET SINGH BAJAJ

M/S BAJAJ & ASSOCIATES
ARCHITECT, ENGINEERS PLANNERS & VALUERS,
SOPHIA MARKET COURT ROAD, SAHARANPUR-247001
TEL.No.- 0132-2724396,098970-86906, 098370-23300
email- manmeet225@yahoo.com

CORPORATE OFFICE :- B-24 GROUND FLOOR
,SEC-44,NOIDA-201301(U.P.)

BRANCH OFFICE :- (01)- H.NO. 197/ 8 / 1 RAJPUR ROAD
,DEHRADUN -248001 (U.K)
(02)- 333 LANE NO 02, SIYA RAM VIHAR
,NEAR INDIAN OIL PUMP, TAKROHI,
INDIRA NAGAR, LUCKNOW 226016(UP)
(03)- H.NO. 5 /1 A, Aman NAGAR, opp
DMW workshop,Patiala

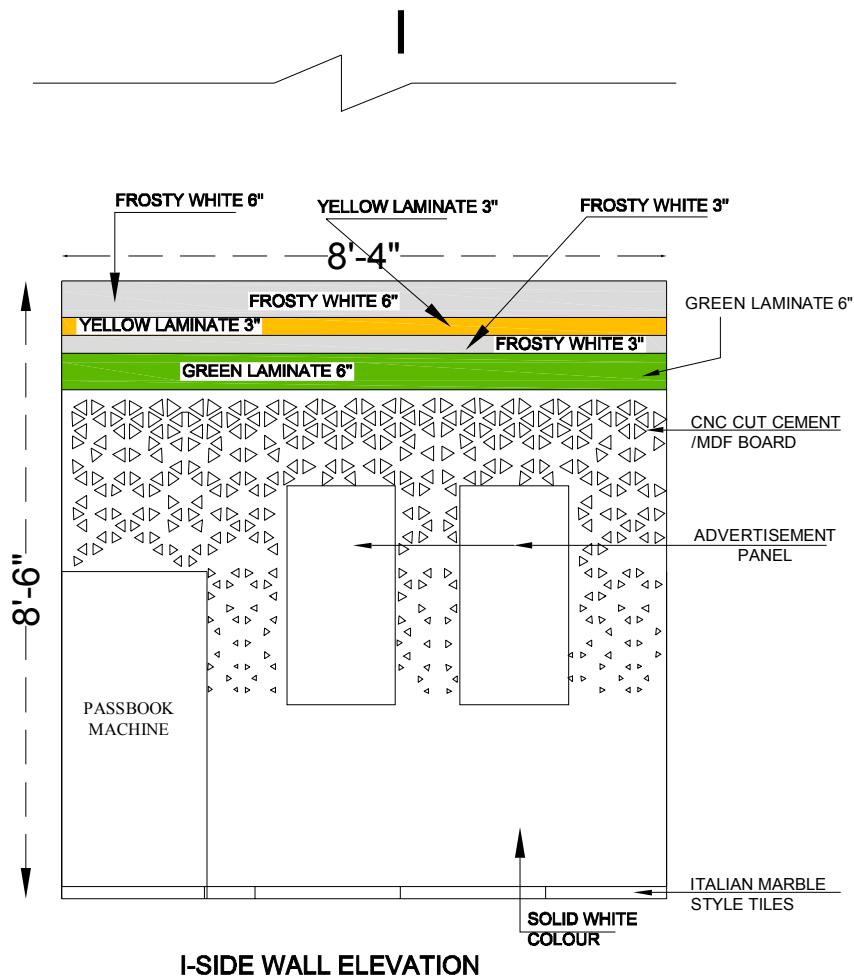
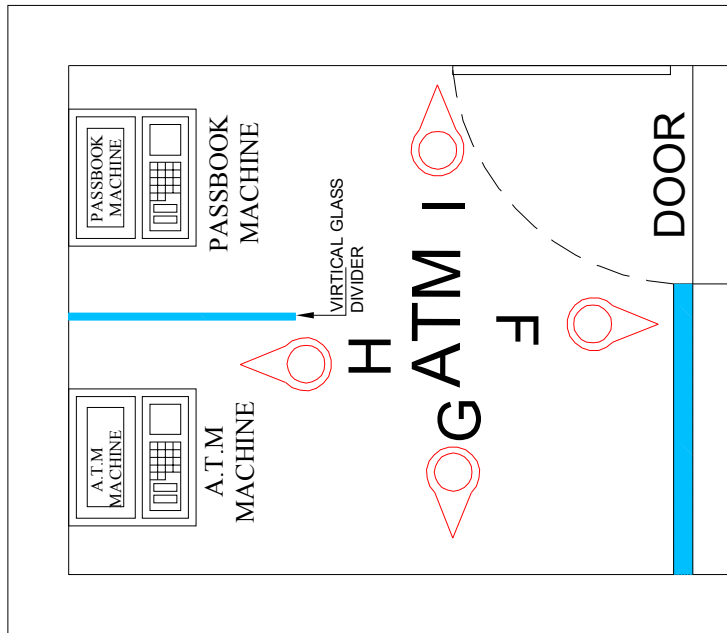

I-SIDE WALL ELEVATION

FILE NO:- P-522/ R-357 /2115-2023

PROJECT.

MODIFIED BUILDING &
PROPOSED INTERIOR
LAYOUT PLAN OF THE
"PUNJAB & SINDH BANK "
BRANCH - **CIVIL LINE**
ROORKEE

I-SIDE WALL ELEVATION - ATM RIGHT SIDE WALL

ANY INQUIREY /INFORMATION
CONTACT TO:- Ar. ABDUL MANNAN
MOB.09997339956,09837933338

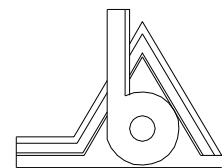

BAJAJ & ASSOCIATES

E S T D : 1 9 7 2

Ar.MANMEET SINGH BAJAJ

M/S BAJAJ & ASSOCIATES
ARCHITECT, ENGINEERS PLANNERS & VALUERS,
SOPHIA MARKET COURT ROAD,SAHARANPUR-247001
TEL.No.- 0132-2724396,098970-66906, 098370-23300
email- manmeet225@yahoo.com

CORPORATE OFFICE :- B-24 GROUND FLOOR
SEC-44,NOIDA-201301(U.P.)

BRANCH OFFICE :- (01)- H.NO. 197/ 8 / 1 RAJPUR ROAD
DEHRADUN -248001 (U.K)

(02)- 333 LANE NO 02, SIYA RAM VIHAR
,NEAR INDIAN OIL PUMP, TAKROHI,

INDIRA NAGAR, LUCKNOW 226016(UP)
(03)- H.NO. 5 /1 A, Aman NAGAR, opp
DMW workshop,Patiala

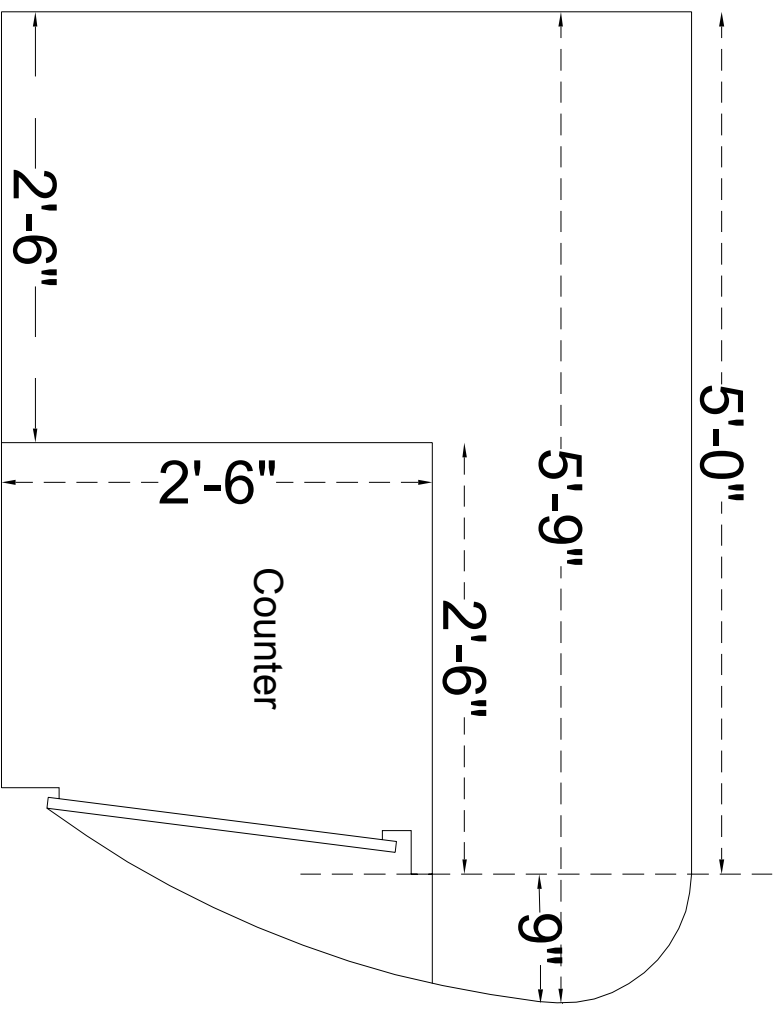
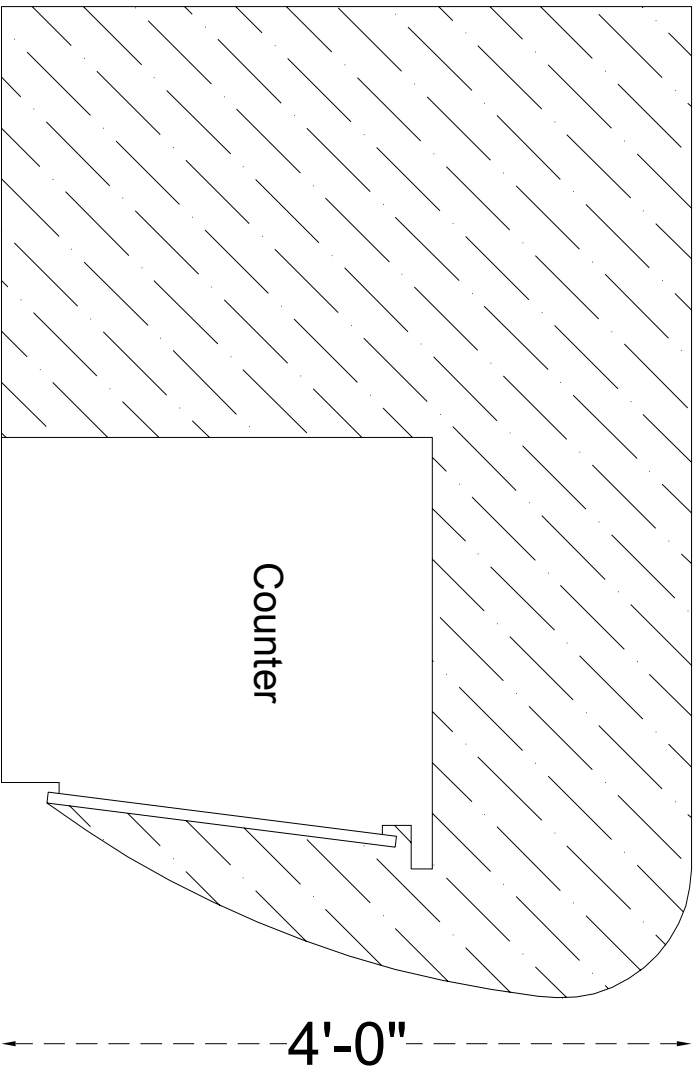

Partition Section

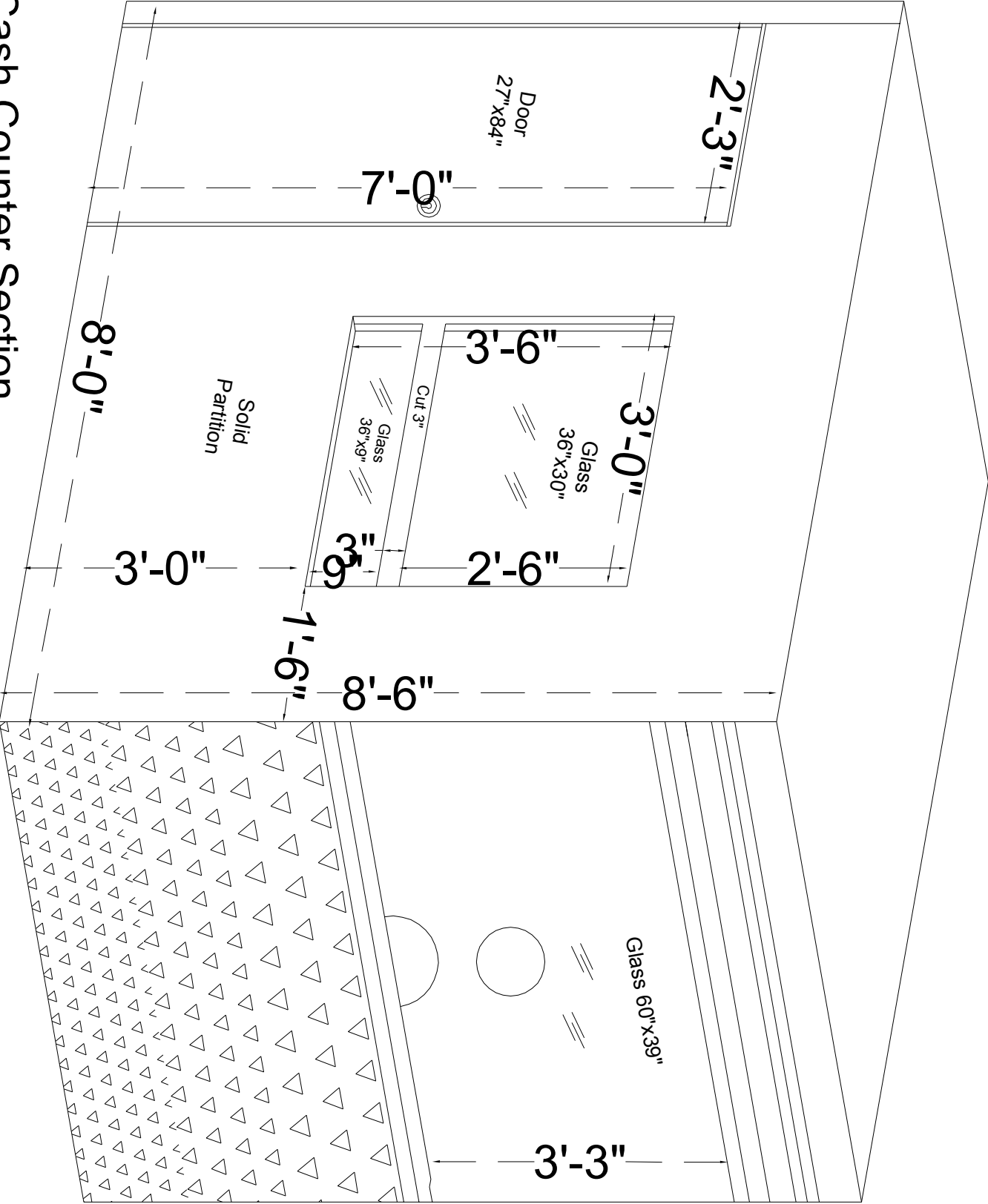

Cash Counter Section